

# Happy Vidhyashry Block-A

RERA No.: RAJ/P/2023/2711

Marketed By :  
  
**Gokul kripa**  
SALES AND MARKETING PVT. LTD.  
AN ISO 9001:2015 CERTIFIED COMPANY  
AN ISO 14001:2015 CERTIFIED COMPANY



Project By :  
**Delight  
Infraheights LLP**



At Village :-Chachiyawas, Sikar Road, Near Bhagwant University, Ajmer, Raj.



# Major Project Attractions

## Govt. Offices

- Rajasthan Mahila Kalyan Mandal Cha. (600 mtr.)
- Inspector General, Registration & Stamps Department (4.9 km)
- Panchayat Training Centre (5.5 km)
- Revenue Research & Training Institute RRTI (8.4 km)
- Ajmer Smart City Office (8.8 km)
- ADA Under Construction New Office (8.9 km)
- RTO Office Ajmer (9 km)
- Sub Registrar Office (10 km)
- Rajasthan Public Service Commission (RPSC), (10.2 km)
- Excise Department (10.2 km)
- Senior Town Planning Department (10.4 km)
- New Board of Sec. Edu. Raj. (RBSE Board) (10.4 km)
- Regional Office Of CBSE (10.6 km)
- District & Sessions Court (11.2 km)
- Police Training Center (11.8 km)
- CRPF Center (12.9 km)
- Management & Commerce Institute of Global (13.6 km)
- NWR Ajmer diesel loco and wagon workshop (15.2 km)
- HMT Machine Tools Limited (18.4 km)
- HMT GSS and JEN office (18.4 km)
- Indian Oil Corporation Servo cfa (18.9 km)
- National Researcher Centre on Seed Spices (24.1 km)

## Hospitals

- Br Shastri Hospital (1.9 km)  
Under Construction
- Janana Hospital (4.1 km)
- Kshetrapal Hospital (8.7 km)
- Bharat Hospital (9.4 km)
- UTTARA Charitable Hospital (10.2 km)
- Mittal Hospital (13.1 km)
- St. Francis Hospital (13.4 km)
- Sewa Mandir Foundation (14.5 km)

## Restaurant & Hotel

- Shakti Resort Puskar Bypass Road (5 km)
- Pratap Mahal, Puskar Bypass (7.8 km)
- Gorbant Garden Restaurant (8.5 km)
- Paradizzo hotel & Resorts (9.1 km)
- Bhanwar Singh Palace (9.7 km)

# Happy Vidhyashry Block-A

RERA No.: RAJ/P/2023/2711

## Shopping Entertainment & Recreational Activity

- D-Mart (9.4 km)
- OM Toyota (10.1 km)
- Vishal Mega Mart (10.1 km)
- Anasagar Chaupati garden (10.9 km)
- Maya Mandir Multiplex Cinema Hall (11 km)
- Subhash Udhyan (11.2 km)
- Patel Stadium (11.4 km)
- Seven wonder Park (12.3)
- Jain Temple, Gyanoday Nagar (15 km)
- Krishi Upaj Mandi (17 km)
- Birla City Water Park (23.6 km)
- Greenland Water Park (25.4 km)

## RIICO Palra Industrial Area (17.5km)

- Sandeep Motors Pvt. Ltd.
- Godrej Agrovet Limited
- IGL CNG & LNG Filling Station
- Multi Auto Car Workshops
- gayatri sands pvt. Ltd
- Parwani Castings & Machines Pvt. Ltd.
- Fatehpuria Machines Pvt. Ltd.
- Agrodaya Products Pvt. Ltd.

## Makhupura Industrial Area (19.6km)

- Shrinath Cargo Private Limited
- Parle Factory
- Laxmi plastic industries
- Ajmer Wood Products Ltd.
- Schoolnet india ltd. fitness centre
- Shri Vishwakarma Engg. Works
- Shree rajasthan industries
- Shree Ambika Cable Machine Private Limited
- Mahindra First Choice Services - 4 Wheeler
- RSRTC Workshop

## Transportation

- Pushkar Bypass Rd (2.2 km)
- Kayad Chauraha (7 km)
- National Highway (NH 8), (7.5 km)
- Ghooghra Helipad (8.8 km)
- Ajmer Dipot work shop Stand (9.2 km)
- Ladpura Road (9.5 km)
- Ajmer Bus Depo (10.9 km)
- Ladpura Railway Station (12.7 km)
- Ajmer Junction (12.7 km)
- Madar Junction (13.3 km)
- Kishangarh Airport (27.6 km)

## School & College

- Bhagwant University, Ajmer (200 mtr.)
- Delhi World Public School (DWPS) (350 mtr.)
- Ajmer Institute of Technology College (2.9 km)
- Medical Collage(Ayurved Nursing College), (4.5 km)
- Aryan College (4.8 km)
- Neerja Modi School (4.8 km)
- RR College of Nursing (5.9 km)
- Sanskriti The School (6.3 km)
- MDS University, Pushkar Bypass Road (7.3 km)
- Sophia Girls' College Ajmer (10.7 km)
- National Military School (11.2 km)
- JLN Medical Collage (11.5 km)
- Prithviraj Chauhan Government College (13.8 km)
- Mayo College Ajmer (14 km)
- Government Engineering college, Kiranipura (15.7 km)
- Dayanand College (17 km)
- Govt. Polytechnic College, Makhupura (19.2 km)
- Govt. Women Engineering College (19.4 km)
- Govt. ITI College (19.8 km)

# ATTRACTIONS OF TOURIST PLACES OF AJMER



**THE AJMER SHARIF DARGAH**



**ADHAI DIN KA JHONPDA**



**ANASAGAR LAKE**



**SONJI KI NASIYAN**



**NARELI JAIN TEMPLE**



**SAI BABA TEMPLE**



**AJMER GOVERNMENT MUSEUM**



**TARAGARH FORT**

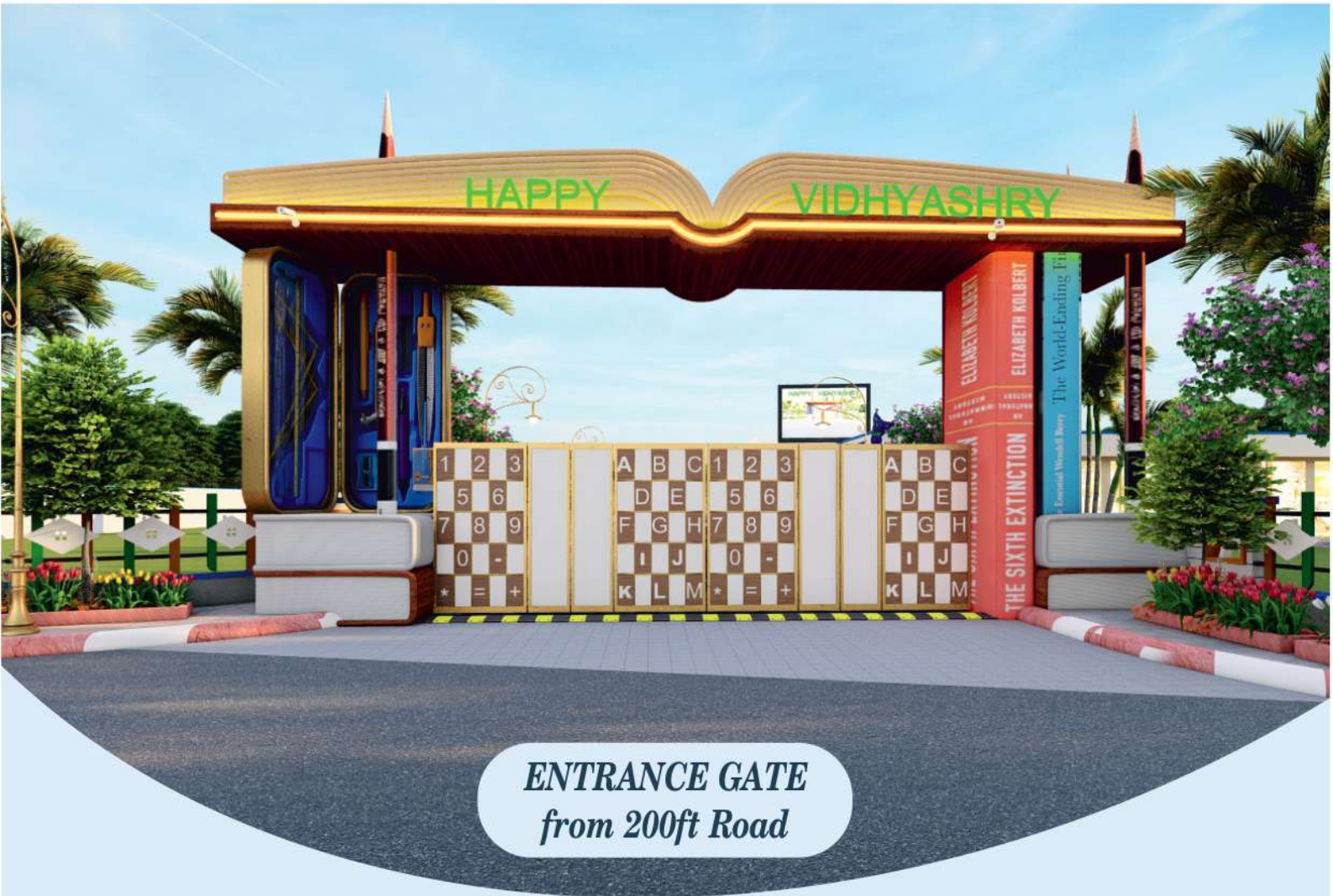

***ENTRANCE GATE  
from 200ft Road***

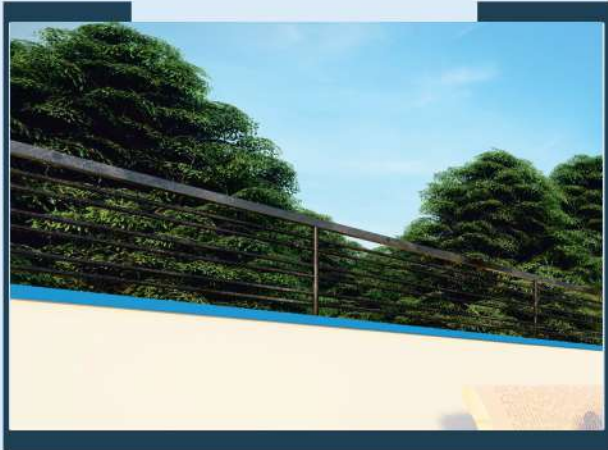

***Outer Boundary Wall with Wire Fencing***



***Interlocking Tiles Road***

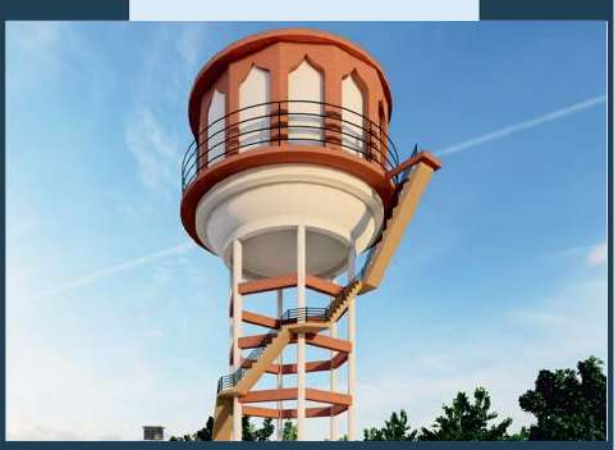

***Water Tank***

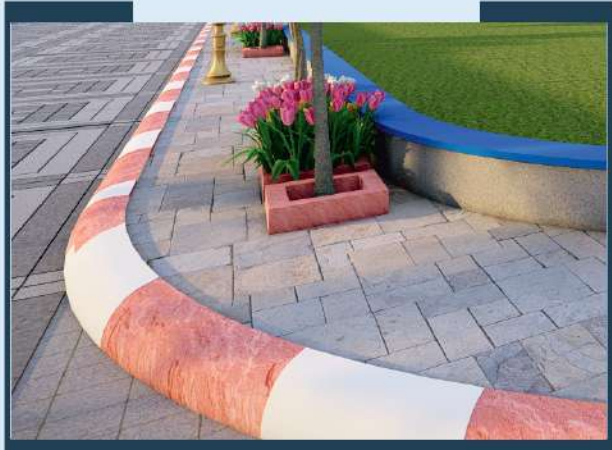

***Curve Stone***



*Park Gate*



*Park Boundary Wall*



*Classic View in Park*



*Classic View in Park*

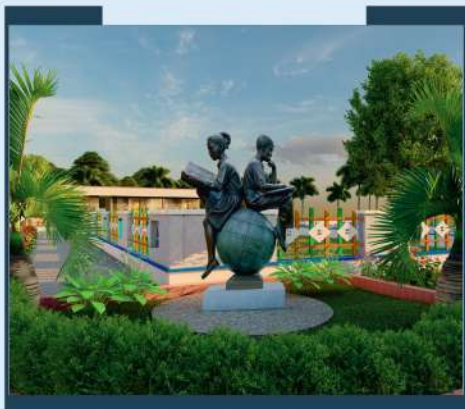

*Classic View in Park*



*Gazebo*



*Kids Play Area*

## Amenities



*Sewer Chamber*



*Underground Electricity*



*Street Lights*

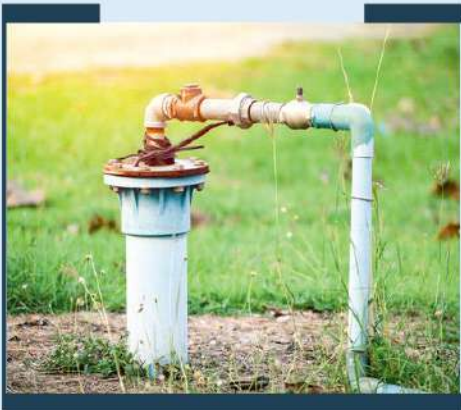

*Water Borewell*

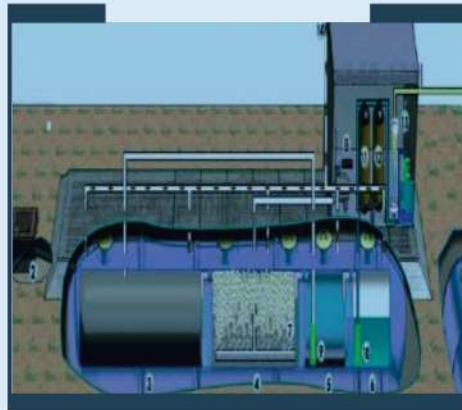

*Sewage Treatment Plant*



*Drip Irrigation*



*Green Plantation*



*CCTV Surveillance  
(Only Entrance Gate)*



*Garbage collection*



*Arrow Plot Demarcation*



*Security Guard  
(For Common Area)*



*Speed Breaker*



*Park Aerial View*



*Retail Shop Area*



*Park Pathway*

***Other Amenities***



*Solar Panel*



*Underground Water Supply Pipe Line*



*Underground Sewer Pipe Line*



*Sitting Bench*